

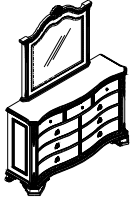

# ASSEMBLY INSTRUCTION FOR

PZB 009 : DRAWER DRESSER  
PZB 010 : MIRROR

Thank you for purchasing this quality product. Be sure to check all packing material carefully for small parts, which may have come loose inside the carton during shipment. Identify and count all parts and compare with the parts list below.



## ASSEMBLY TIPS:

- 1.Remove hardware from box and sort by size.
- 2.Please check to see that all hardware and parts are present prior start of assembly.
- 3.Please follow attached instruction in the same sequence as numbered to assure fast and easy assembly



## WARNING!

- 1.Don't attempt to repair or modify parts that are broken or defective. Please contact the store immediately.
- 2.This product is for home use only and not intended for commercial establishment.
- 3.Two persons are required for assembly.
- 4.Approximate assembly time : ½ hours

## HARDWARE LIST:

Component parts and fittings in the box.  
Please sort out all parts before you begin to assemble the item.  
This is to make sure you always use the correct part.

## HARDWARE LIST OF MIRROR

G		ALLEN KEY	5MM	1 pc
E		SPRING WASHER	Ø1/4 "	8 pcs
D		FLAT WASHER	Ø1/4"(19mm)	8 pcs
F		BOLT	Ø1/4"x1"-1/2	8 pcs

## DRAWING:

Warning: Keep small components out of the reach of children!



Parts Enclosed Box 2:

• (1)Dresser-(A)



Parts Enclosed Box 2:

• (1)Mirror-(B)



• (2)Mirror Support-(C)

## HARDWARE LIST

1		Tipping Hardware	1 set
---	--	------------------	-------

REMARK:There is a tip restraint kit provided on the back of this product please read the direction thoroughly and Install Immediately

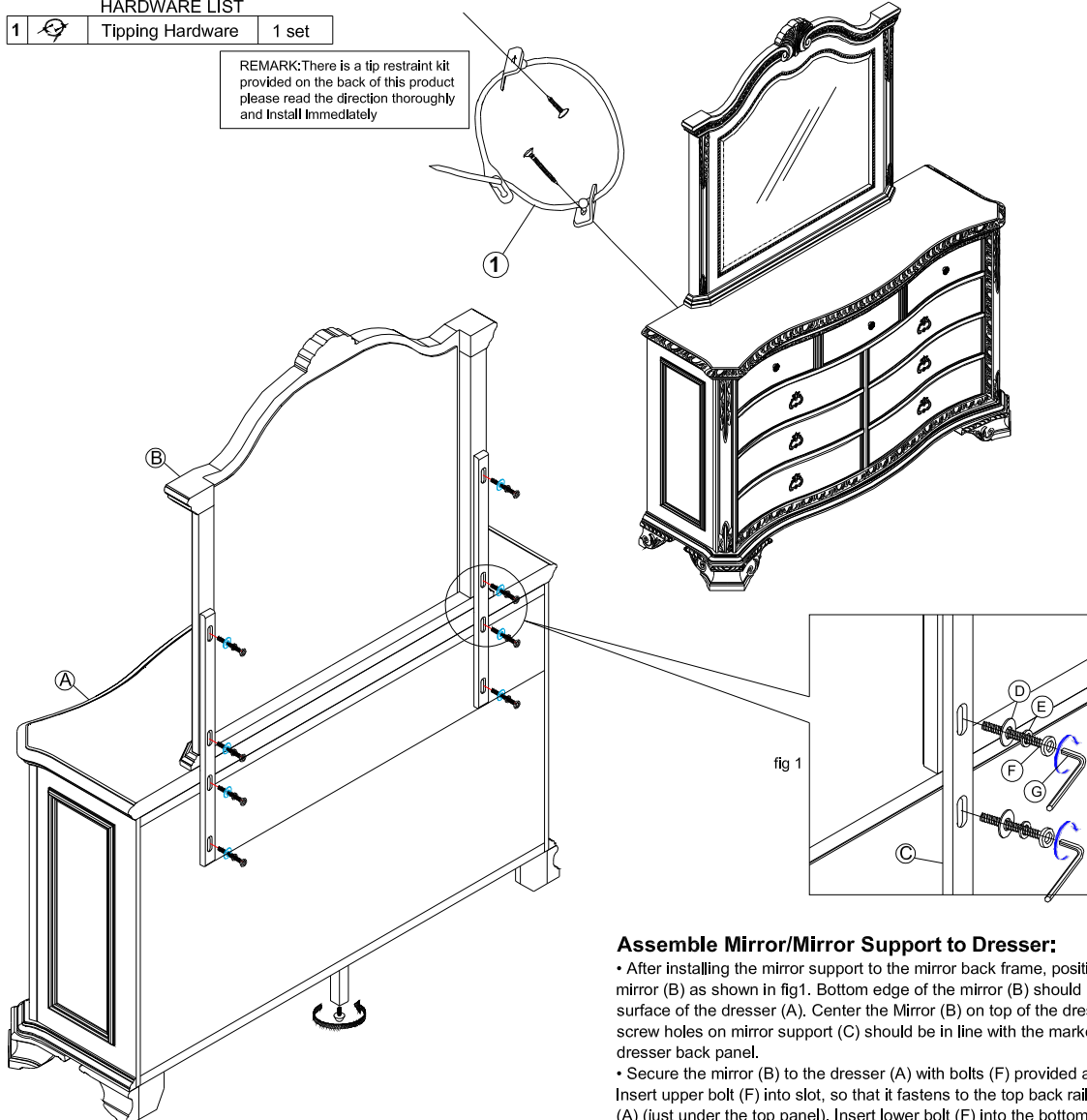

## Assemble Mirror/Mirror Support to Dresser:

- After installing the mirror support to the mirror back frame, position the mirror (B) as shown in fig1. Bottom edge of the mirror (B) should rest on the top surface of the dresser (A). Center the Mirror (B) on top of the dresser (A). Bottom screw holes on mirror support (C) should be in line with the marker line on the dresser back panel.
- Secure the mirror (B) to the dresser (A) with bolts (F) provided as shown in fig1. Insert upper bolt (F) into slot, so that it fastens to the top back rail of the dresser (A) (just under the top panel). Insert lower bolt (F) into the bottom screw hole on each mirror support (C).

Simply wipe off the furniture with a damp cloth and buff dry with another soft cloth periodic polishing with a non silicone furniture polish will retain the luster

MADE IN VIET NAM