

# ASSEMBLY INSTRUCTION

## DESCRIPTION: Type 06 BABY BOOM

### 2.5 hrs

APPROXIMATE ASSEMBLY TIME  
EXCLUDING GLUE SETTING TIME

2 PERSON ASSEMBLY



FLOOR AREA  
2,5M X 2,5M

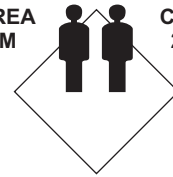

CEILING HEIGHT  
2,0M

REQUIRED ASSEMBLY SPACE

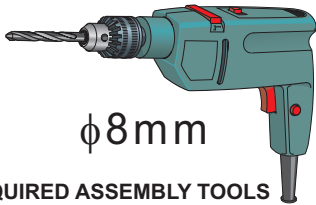

$\phi 8\text{mm}$

REQUIRED ASSEMBLY TOOLS

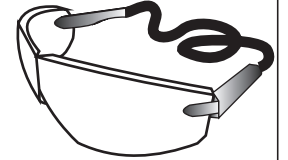
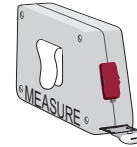

ASSEMBLED DIMENSIONS

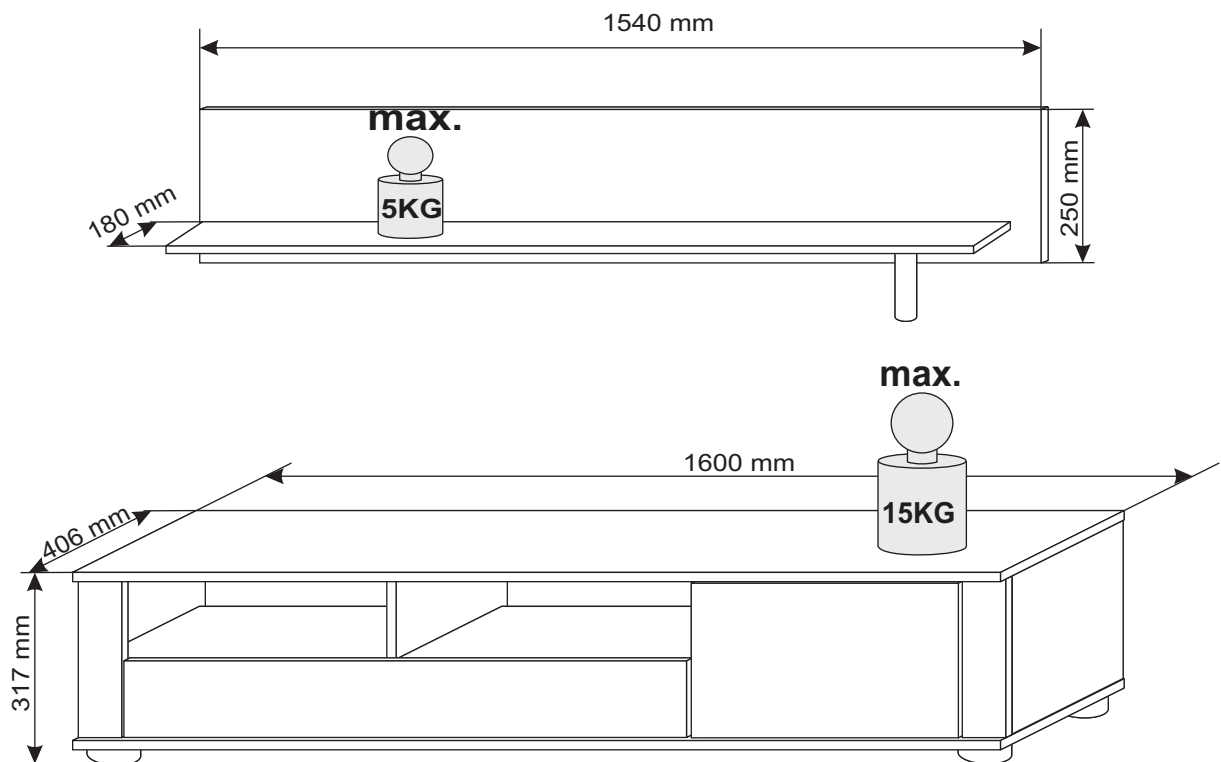

# PART LIST

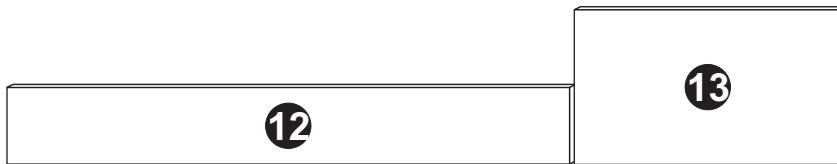
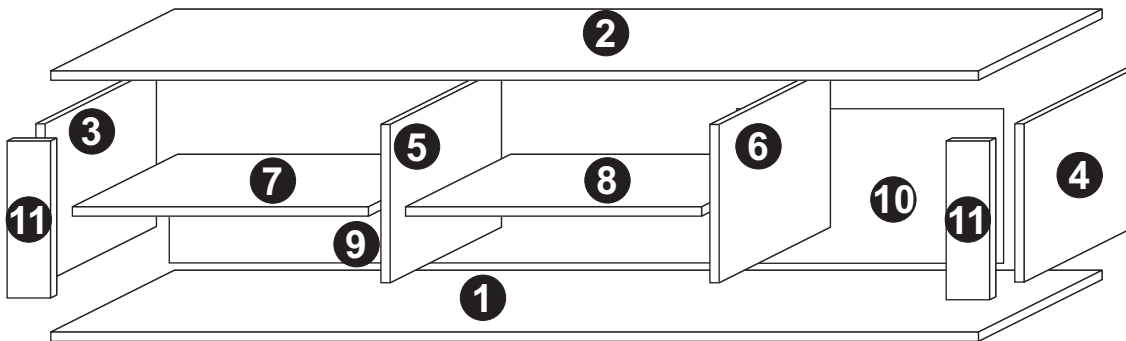
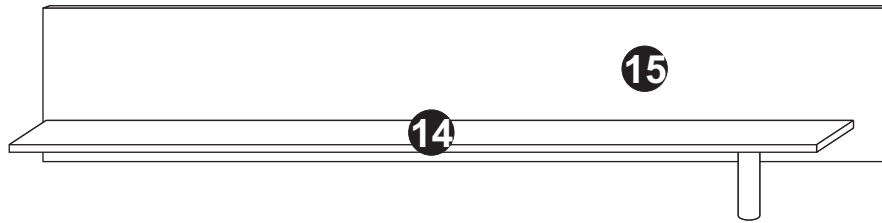

NO. PARTS LIST	QTY	NO. PARTS LIST	QTY
(1) BOTTOM PANEL	1	(14) HANGING SHELF	1
(2) TOP PANEL	1	(15) BACK PANEL	1
(3) LEFT SIDE PANEL	1		
(4) RIGHT SIDE PANEL	1		
(5) LEFT DIVIDER	1		
(6) RIGHT DIVIDER	1		
(7) LEFT HORIZONTAL DIVIDER	1		
(8) RIGHT HORIZONTAL DIVIDER	1		
(9) LEFT BACK PANEL	1		
(10) RIGHT BACK PANEL	1		
(11) PLINTH	2		
(12) LEFT FLAP	1		
(13) RIGHT FLAP	1		



# HARDWARE LIST

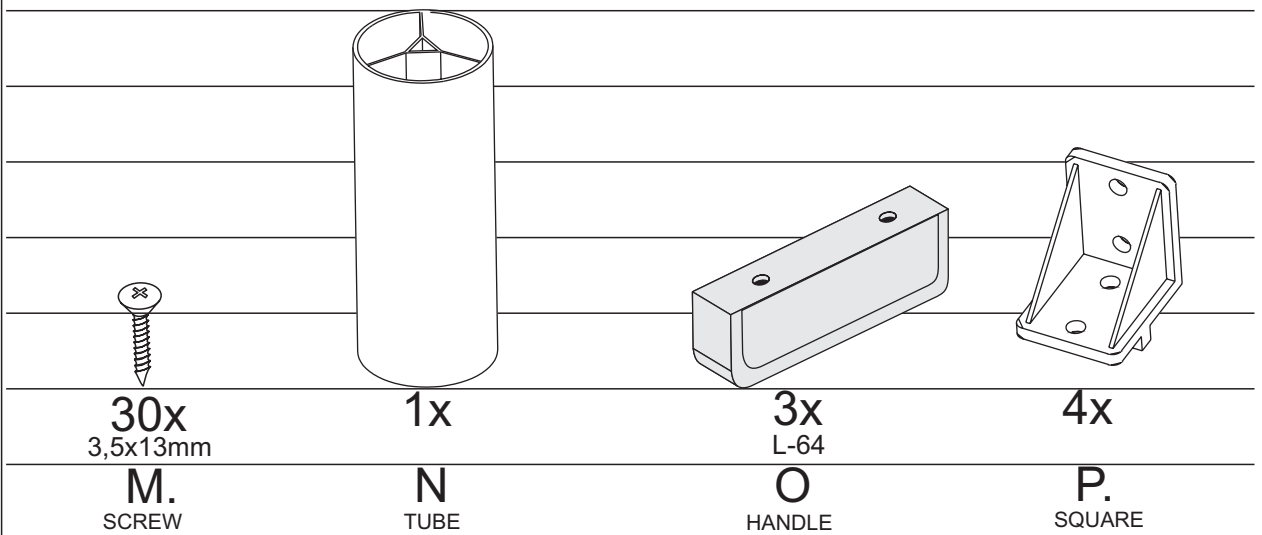
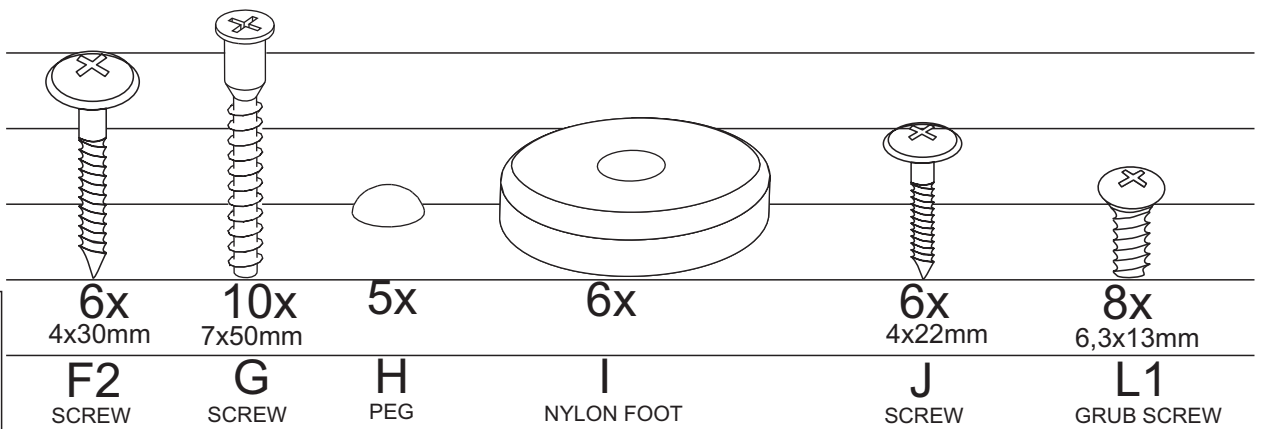
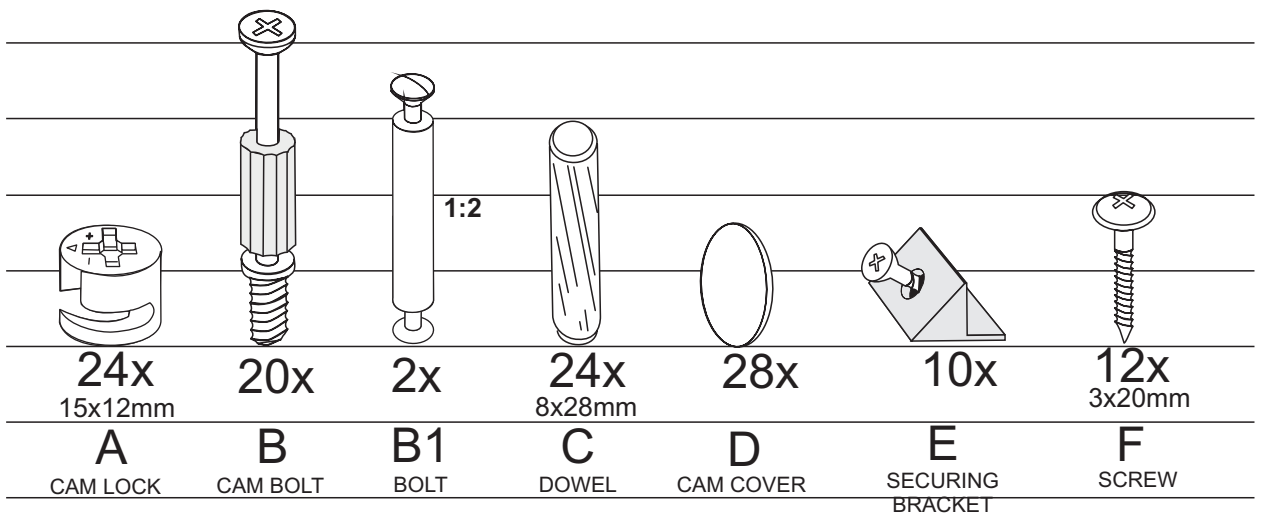

# HARDWARE LIST



1x  
U

FLAPS SETTING INDICATOR

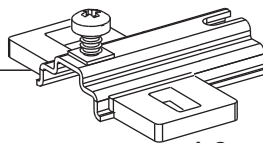

1:2

4x  
H-2  
V

HINGE PLATE

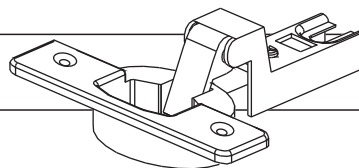

4x  
Kr15  
W1

HINGE

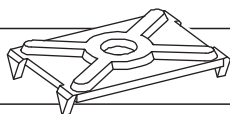

2x

X  
METAL  
PLATE



## **Top Tips before you start!**

1. Please check that all parts are present before you start the assembly of your furniture, as once assembled, the furniture is exempt from our home approval policy.
2. For ease and speed of assembly, we recommend that before you commence each step of the assembly, that you identify all the parts required for that step.
3. For larger items, please ensure that you have sufficient space and people ( as indicated on page 1) to assemble your product safely.
4. We recommend that, where possible, all items are assembled near to the area in which they will be placed in use, to avoid moving the product unnecessarily once assembled.
5. For the protection of your furniture, particularly items of high gloss finish, we recommend that the product is placed on a protected surface during assembly to prevent any damage.
6. During assembly please take care not to over-tighten any fittings, as this may damage the product .

## **Care and Maintenance of your Furniture**

Please periodically check all fittings and re-tighten as necessary.

Please do not sit or stand on this item.

Never allow any kind of liquid to remain on your furniture. Absorption can cause wood to warp or finishes to de-laminate.

Please do not drag and pull your furniture.

# SPECIAL TIPS FOR FITTING CAM-LOCKS AND CAM-PILLARS

## CAM-LOCK

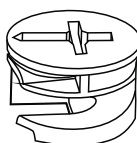

WHEN FITTING CAMS  
ENSURE STARTING POSITION IS CORRECT  
BEFORE YOU INSERT CONNECTING CAM-PILLAR  
TURN CLOCKWISE UNTIL SECURE

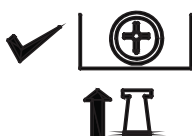
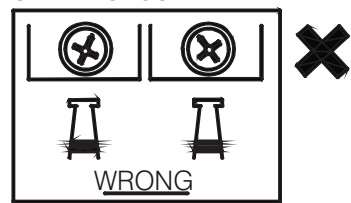
Align with long point of cross

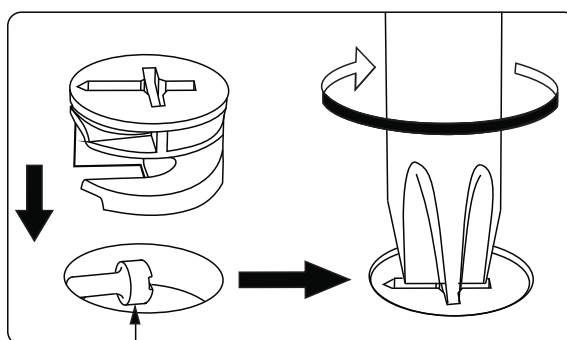

Pillar head needs to be in centre

## CAM-PILLAR

Tighten until shoulder is flush with panel. Do not overtighten or undertighten (see example below)

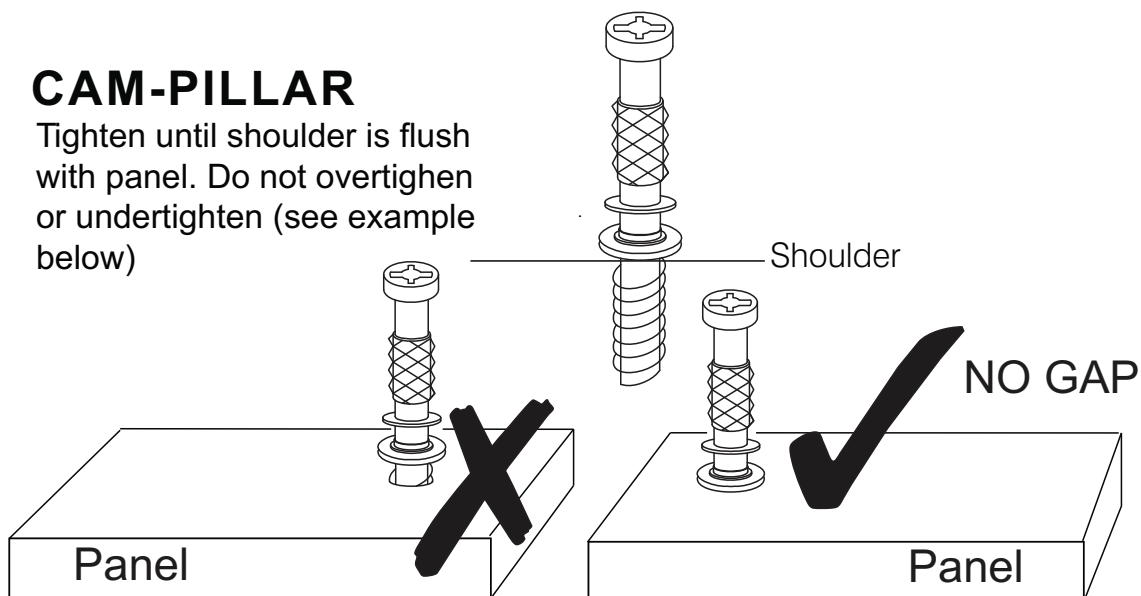

# STEP 1

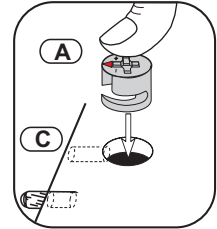
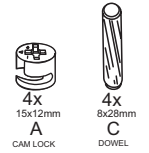
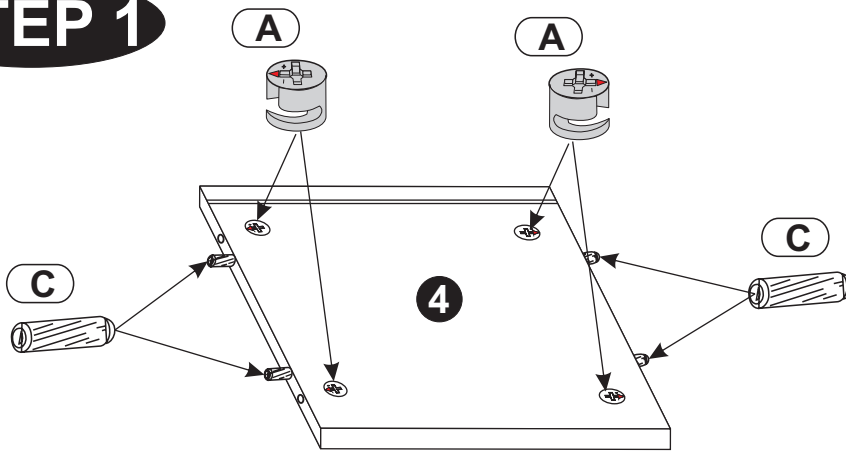

# STEP 2

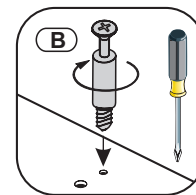
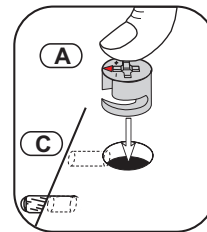
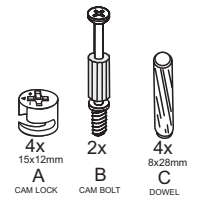
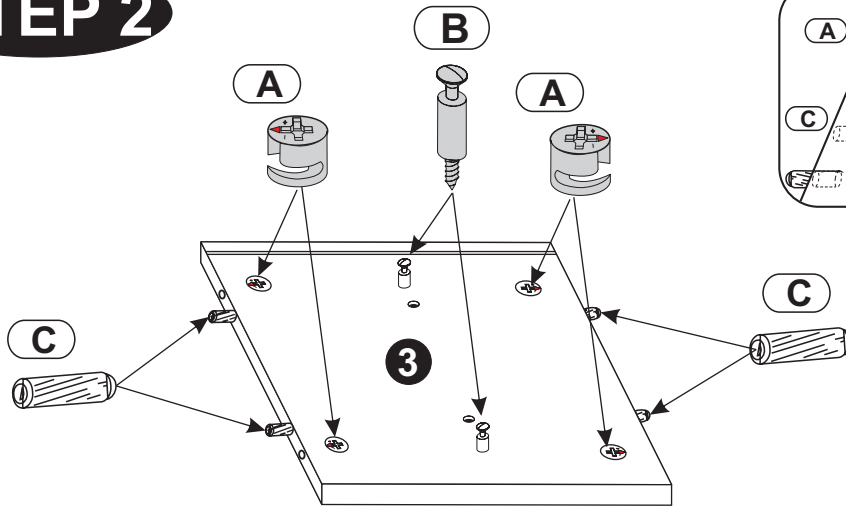

# STEP 3

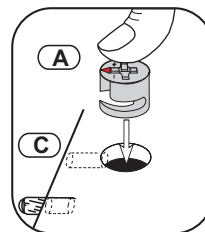
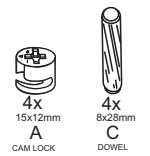
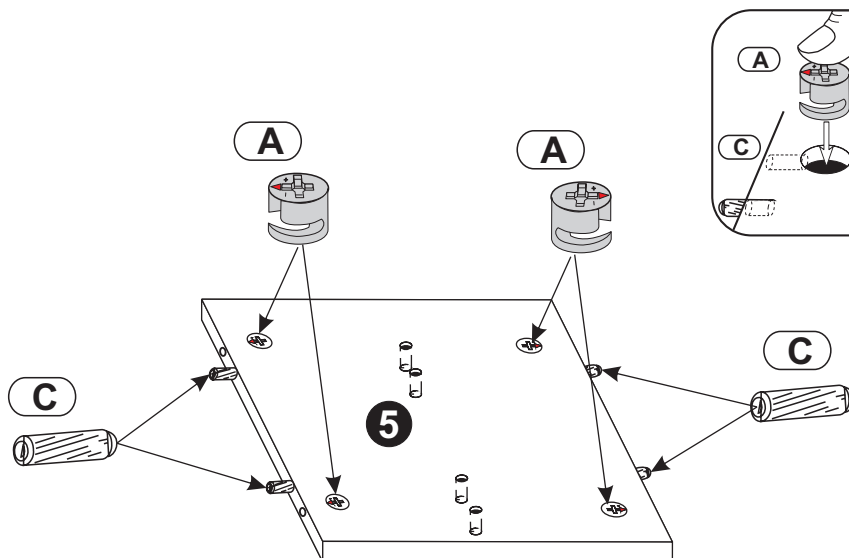

# STEP 4

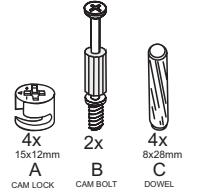
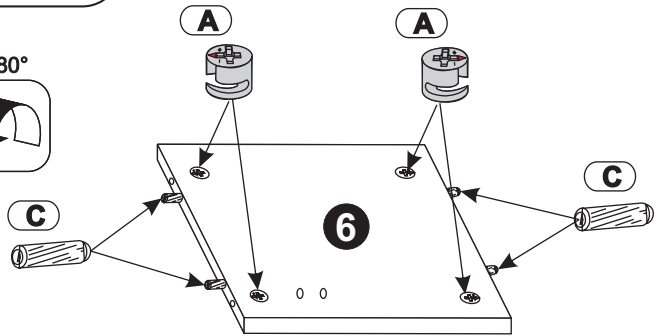
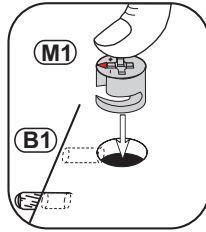
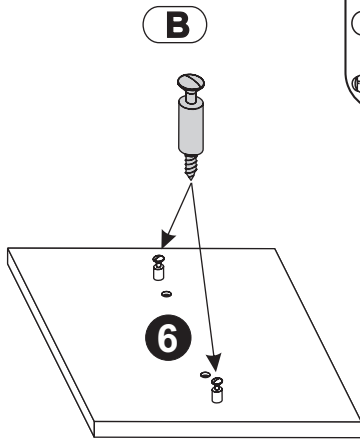
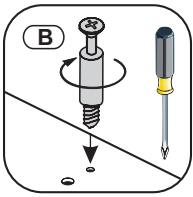

# STEP 5

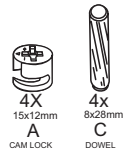
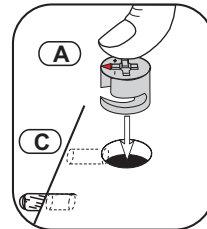
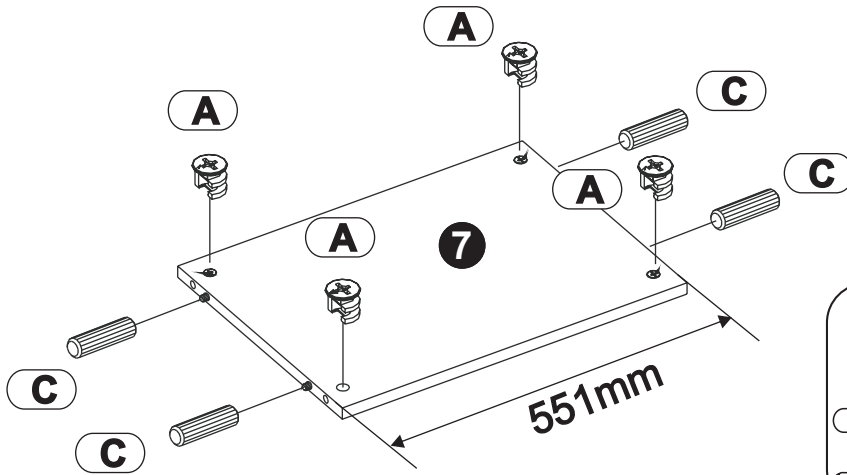

# STEP 6

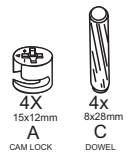
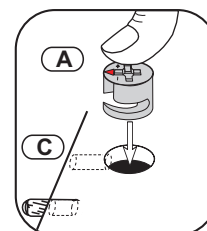
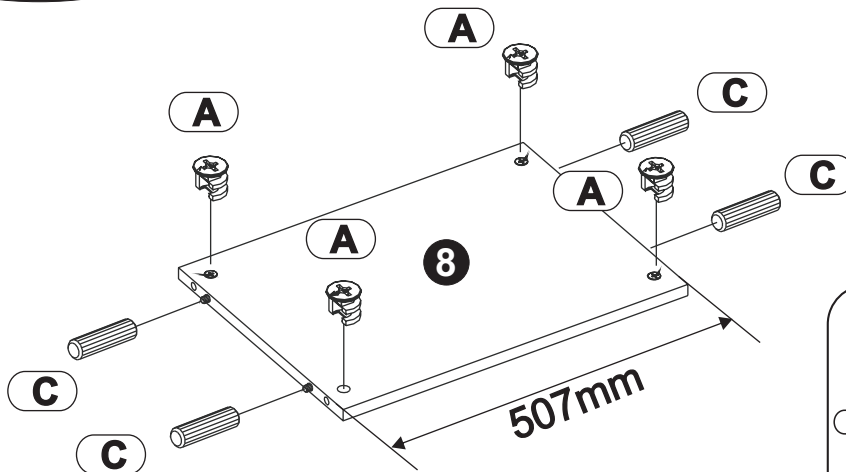



# STEP 7

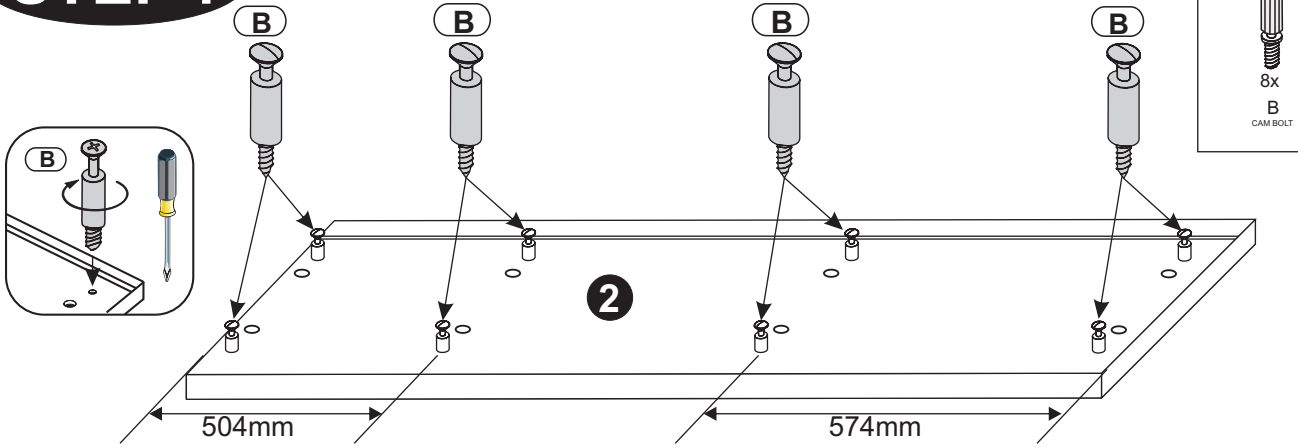

# STEP 8

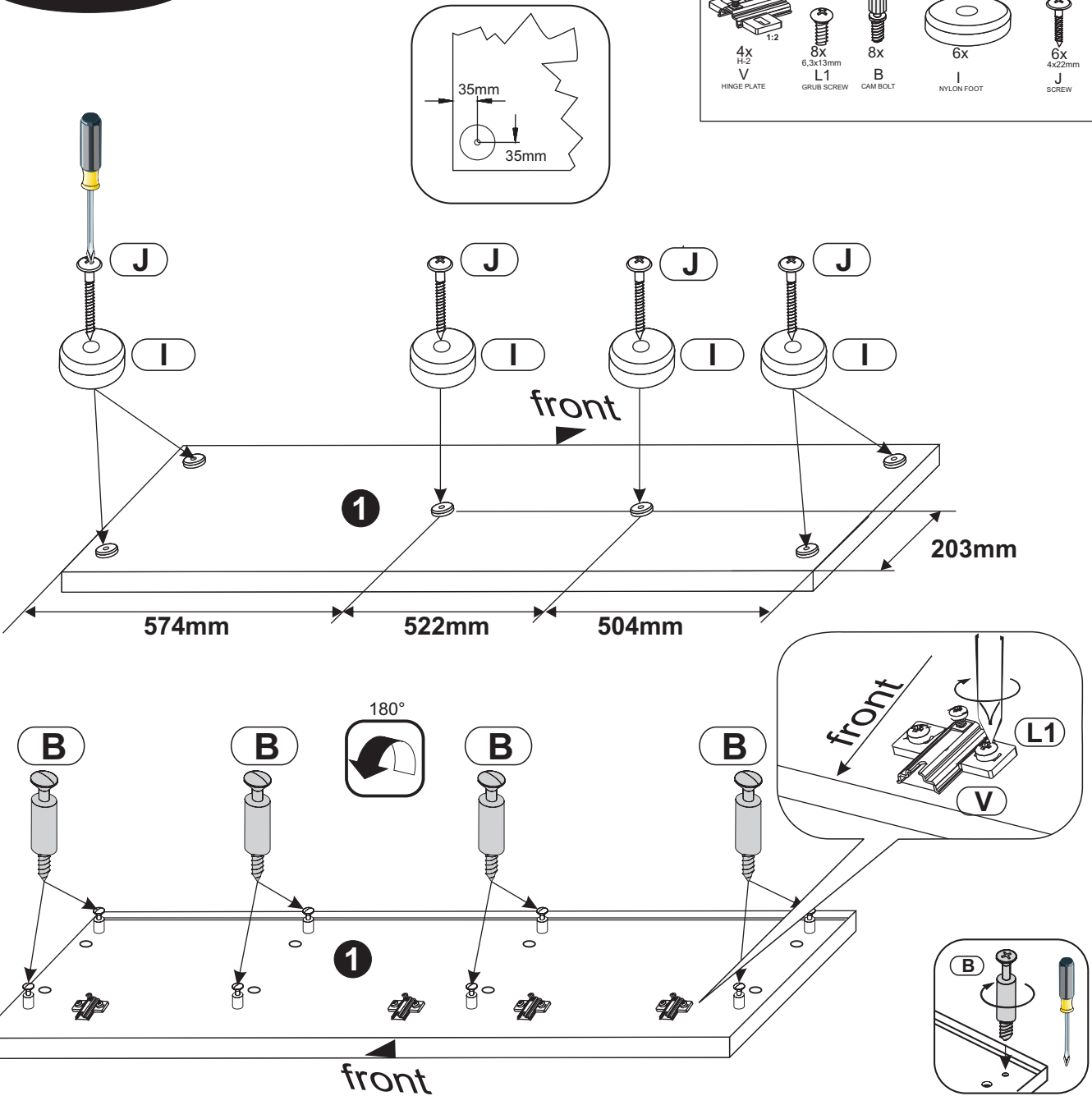

# STEP 9

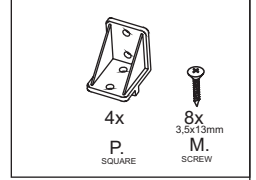
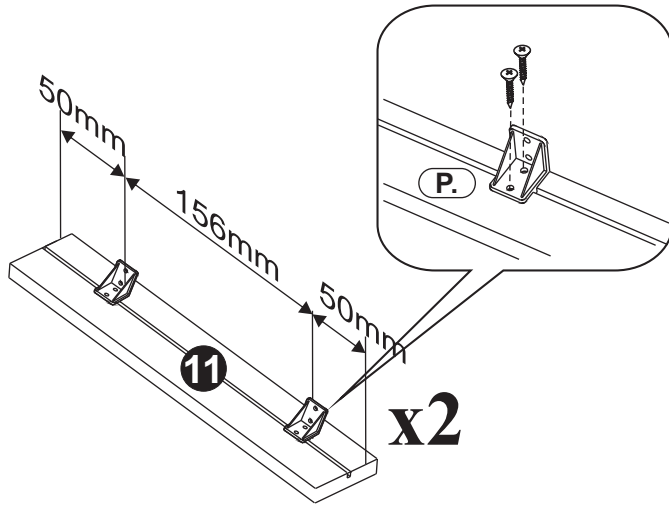
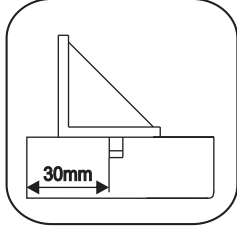

# STEP 10

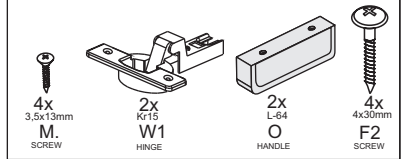
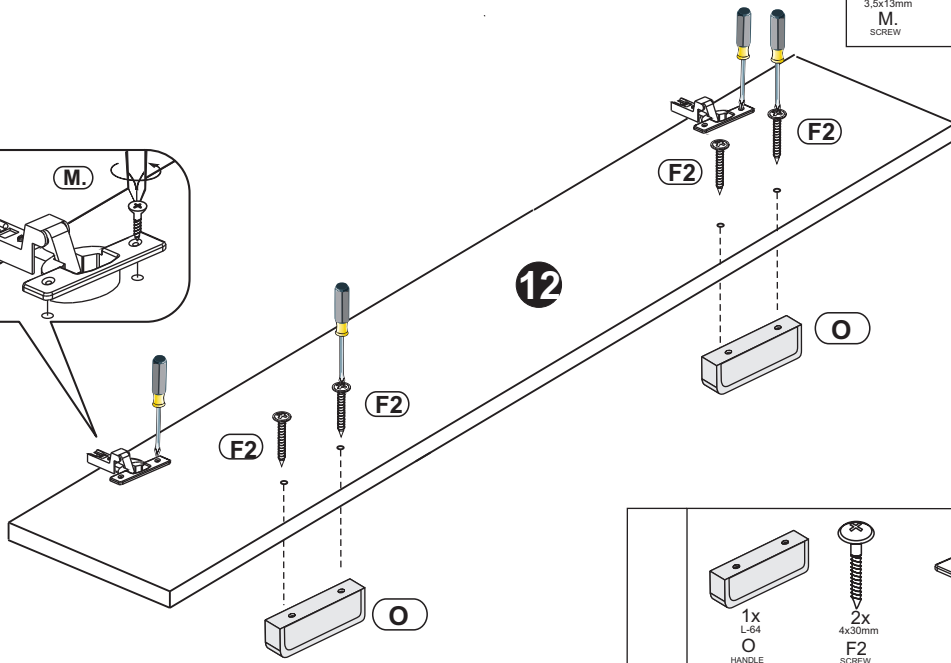
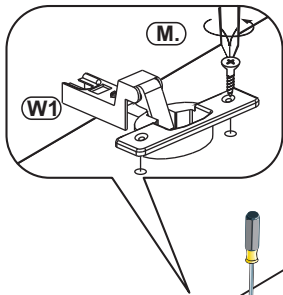

# STEP 11

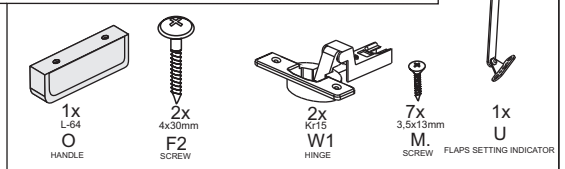
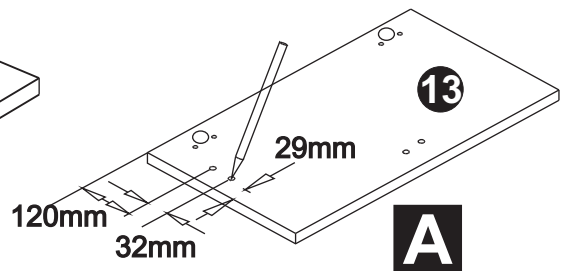
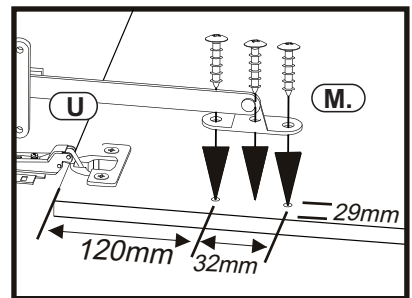
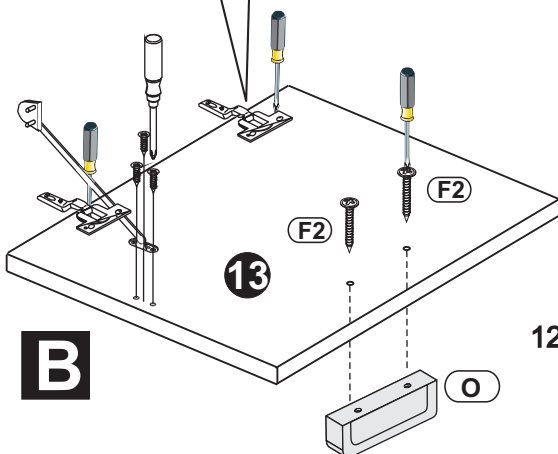
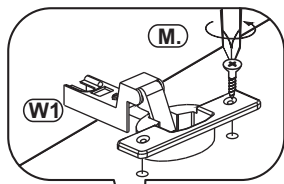

# STEP 12

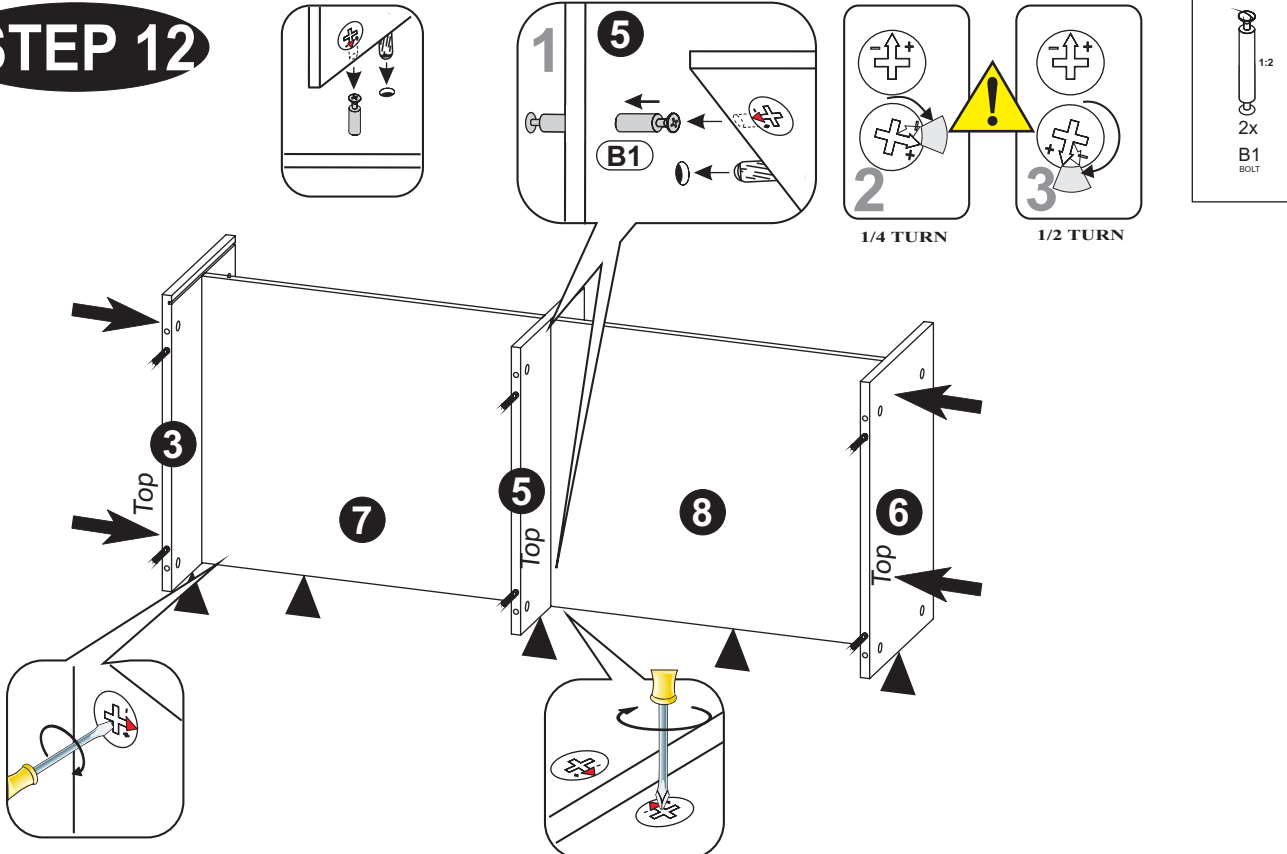

# STEP 13

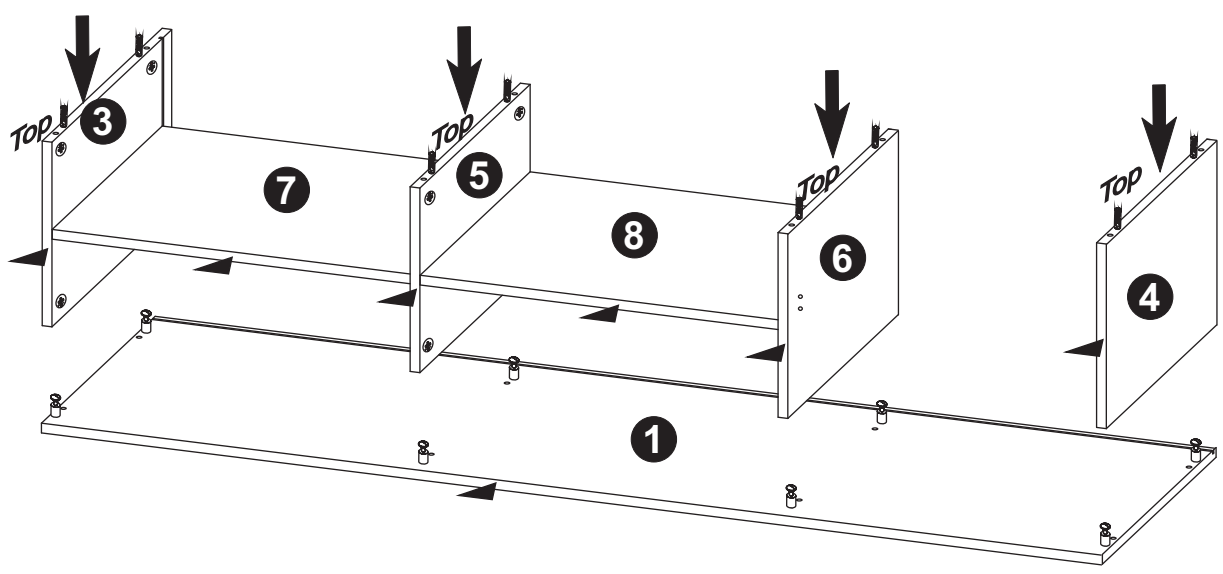

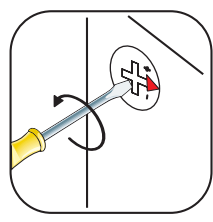
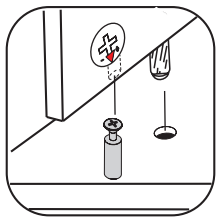
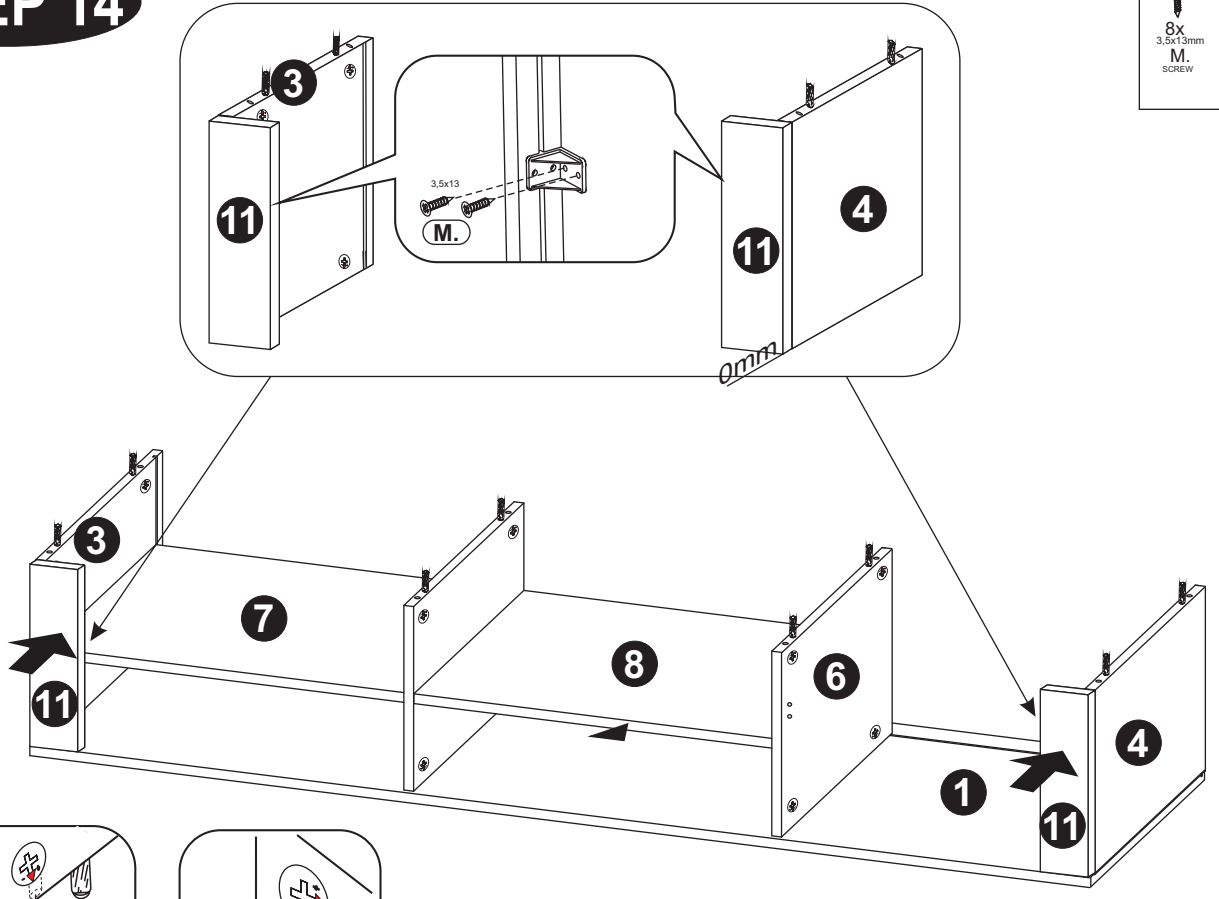

# STEP 14

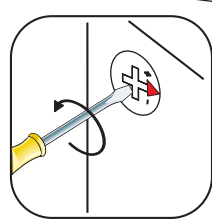
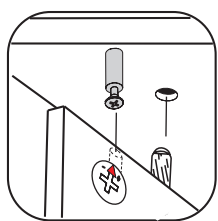
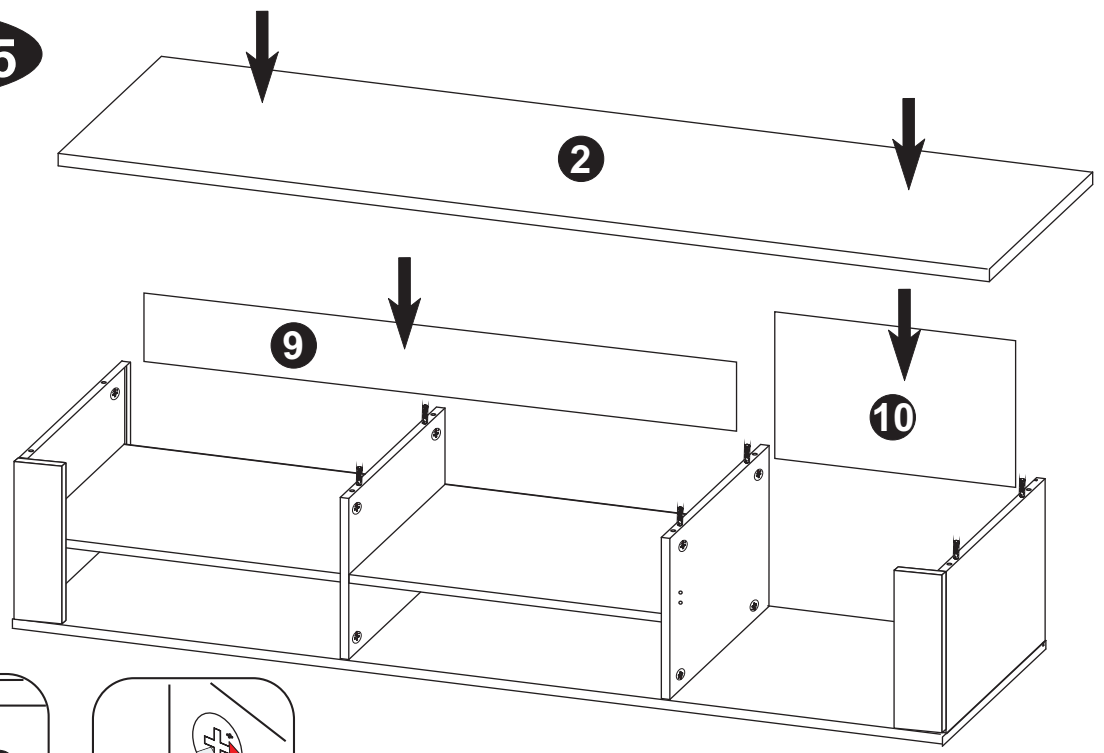

# STEP 15



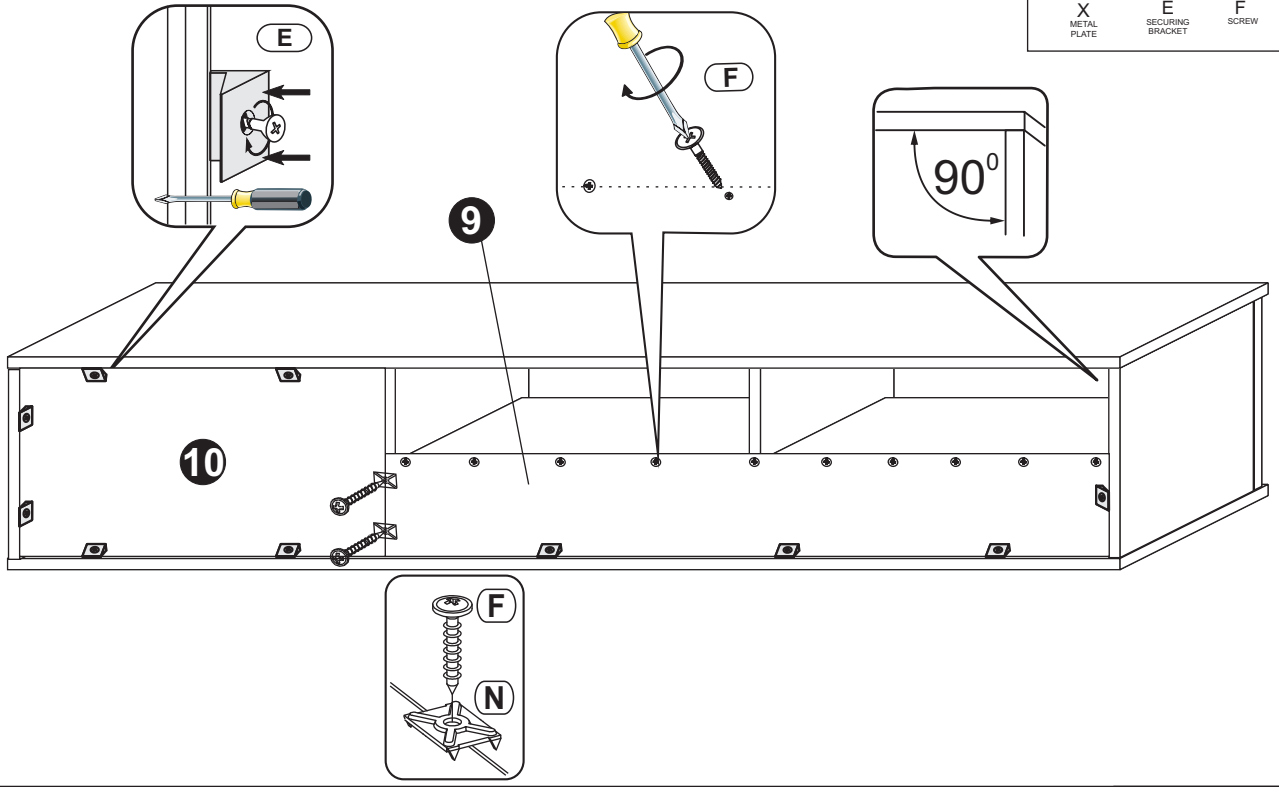

# STEP 16

-  2x  
X  
METAL  
PLATE
-  10x  
E  
SECURING  
BRACKET
-  12x  
3x20mm  
F  
SCREW



# STEP 17

-  5x  
H  
PEG
-  3x  
3,5x13mm  
M.  
SCREW
-  24x  
D  
CAM COVER

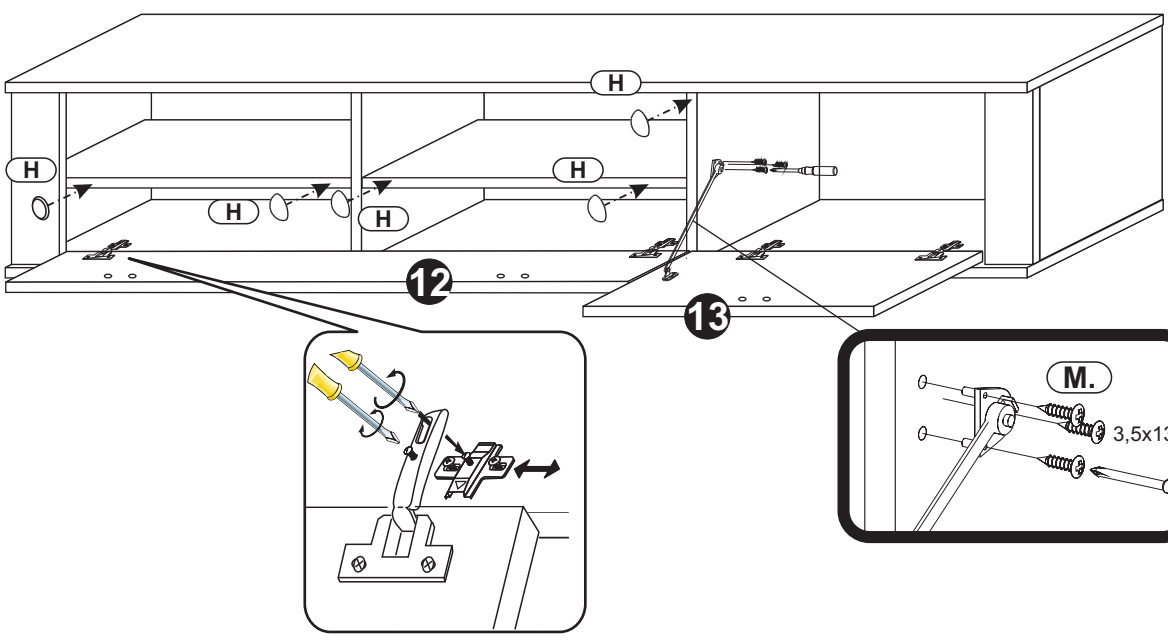
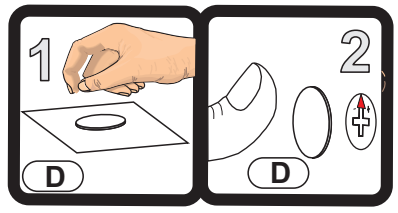

# STEP 18

- 7x  
7x50mm  
G  
SCREW
- 1x  
N  
TUBE

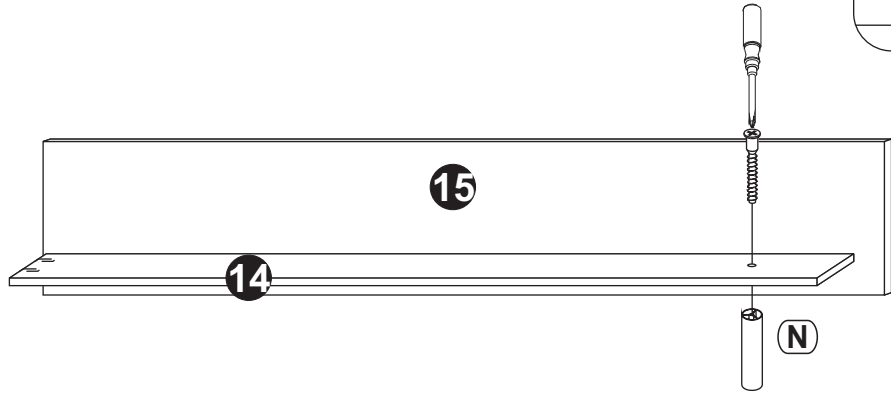
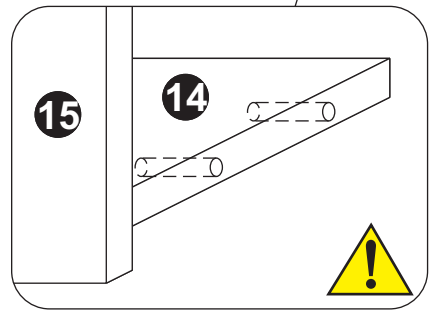
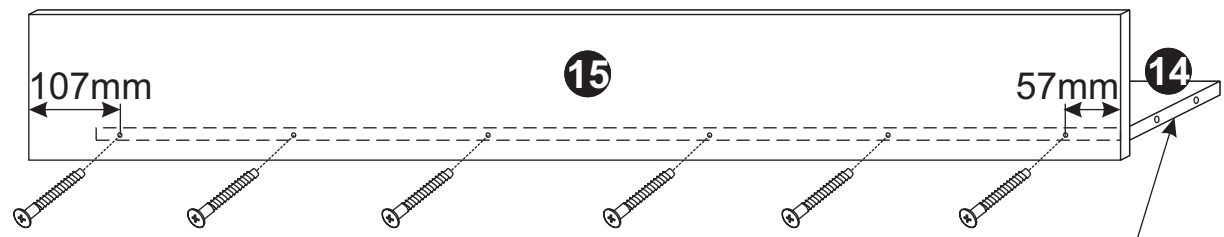
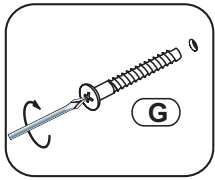

# STEP 19

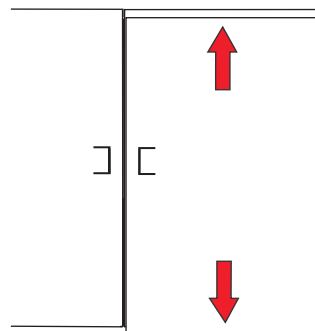
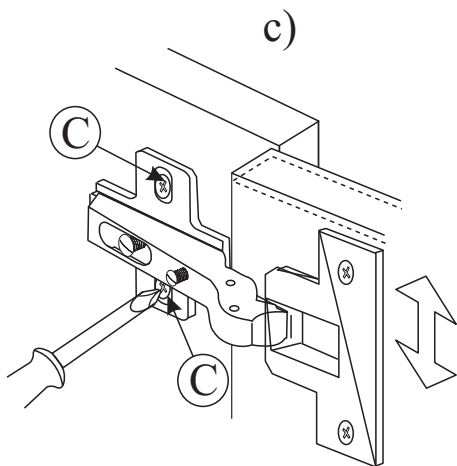
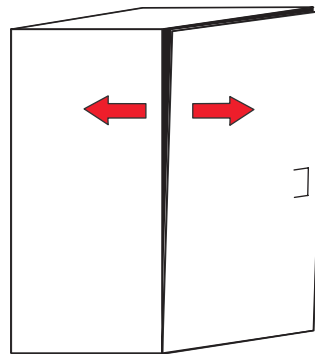
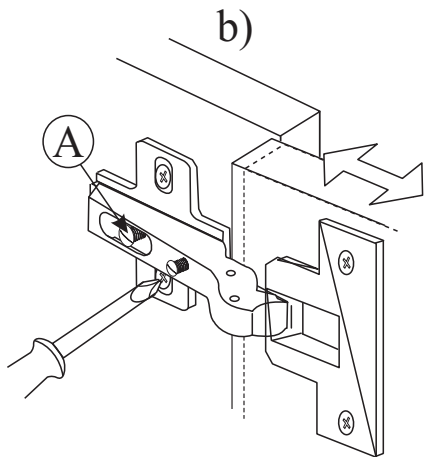
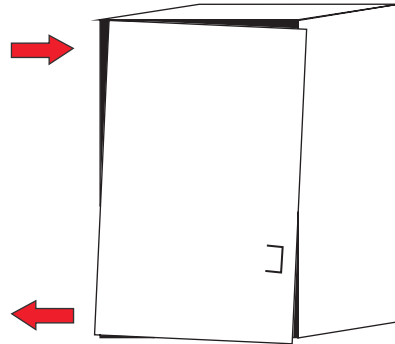
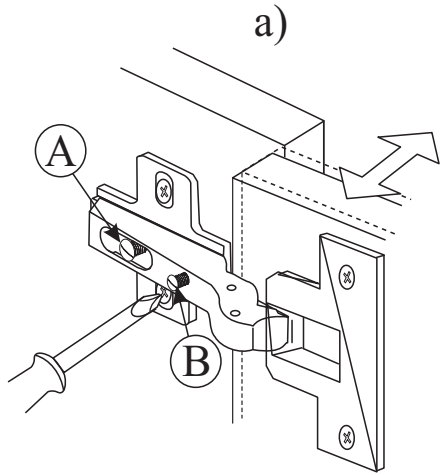

# STEP 20

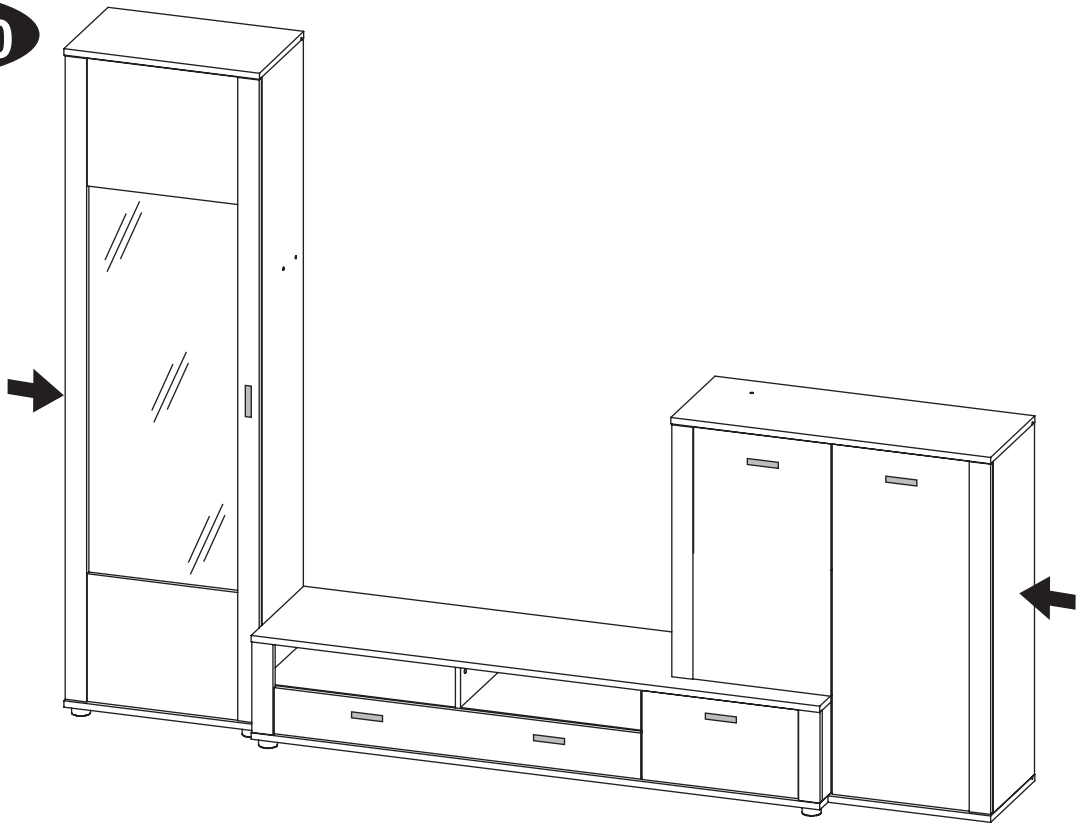

# STEP 21

 LED Lights in type 10  
Cam Covers for LED in type 10

